

Toneway Update

As you may be aware, works to widen the Toneway are now underway with lane closures in place.

The Toneway in this area is concrete which means we will need to dig out each section and replace the concrete before moving onto the next section, paying regard to the drainage and underground utilities in each section.

Whilst doing this we shall be moving the traffic management as we go but for safety reasons, we will always have two lanes inbound and one lane outbound.



This will have an impact on journey times and we are monitoring this closely. We are aware there were initially issues with traffic leaving the Hankridge Business Park. Following feedback from drivers and traders, we reacted quickly to install a temporary yellow hatching box on the Heron Gate Roundabout. This appears to have helped improve traffic flow but we will continue to monitor and make changes where possible.

Now the traffic management is in place our teams are making good progress with the works.

Thank you for your patience throughout these essential phases of work.

M5 Junction 25 Improvement Scheme – July/August 2019 – Continued

M5 Junction 25 Roundabout & Link Road



We have excavated and widened Junction 25 roundabout facing the Toneway. It had been widened and recently surfaced in preparation for the extra lanes. This work has been undertaken at night to avoid day-time congestion.

Whilst work continues on Toneway we are also working concurrently in the area behind the Park and Ride site. This is the area where the old poultry sheds used to be.

The white areas are geotextile matting to reinforce the earth for what will be the future Nexus 25 Link Road.



Next Phase

During August a piling rig will arrive on-site and be established near the Blackbrook River. The piling rig will be used to form the foundations for the structure over the river for the new Link Road. This work will happen concurrently with other activities across the project and will be kept clear from the live carriageway in order to minimise any disruption.

We will be surfacing the old grass central reserve along the Toneway. This will give us enough road width to maintain two lanes of traffic inbound to Taunton and reduce congestion on the Junction 25 roundabout. The work to lift up the old concrete carriageway on Toneway can then begin.

A large Band Drain Machine has arrived on the New Link Road side of Junction 25. Band Drains are an economical solution for treating large areas where levels are being raised for flood protection or reclamation. Band Drains consist of a permeable plastic core wrapped in a filter membrane which is pushed into the ground to design depth.

M5 Junction 25 Improvement Scheme – July/August 2019 – Continued

Footpath Closure

For safety reasons, it has been necessary for us to temporarily close the Public Right of Way where we are now working in the area of the New Link Road near the Park and Ride.

The footpath has been diverted as per the map and the diversion route is clearly signed.

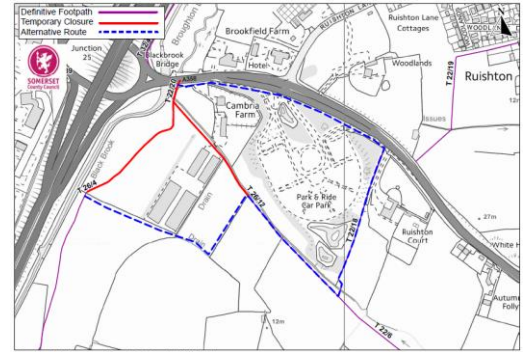

Drone Footage

Further images and video of the scheme and the progress that is being made can be viewed on our website: <https://community.alungriffiths.co.uk/projects-in-your-area/m5-j25-taunton/progress-videos/>

Safety Stand-Down

A safety stand-down day was arranged to facilitate MGF (our drainage system supplier) to give our staff training on their system. The objective was to ensure all Operatives working on Junction 25 had a consistent presentation from MGF on the safe use and installation of their trench support systems. We also used the event to introduce our permit to dig system and upskill Operatives on working around services such as gas, electric and water.

MGF provided an hour-long presentation followed by a 15-question quiz to ensure everyone that attended the presentation understood its contents.

Our Management Team on Junction 25 provided a BBQ to say thank you to our staff for all their continued hard work.



Our Operatives and Civil Engineers working on Junction 25 at the Safety Stand-down Day

M5 Junction 25 Improvement Scheme – July/August 2019 – Continued

Subscribe to our Newsletters

If you would like to subscribe to receive future Newsletters and Bulletins, please click [HERE](#) and complete the online form for Mail Chimp. OR use this QR code.



We would be pleased to hear your comments. You can get in touch via our web site community.alungriffiths.co.uk or by contacting our Public Liaison Officer Jim Aitken on 0330 041 2184* or M5J25@alungriffiths.co.uk

*Calls to this number are charged at national call rates and included in inclusive minute plans from landlines and mobiles

Travel Somerset – for live travel alerts, roadworks information and winter weather updates

On Twitter @TravelSomerset and online 24/7 at <https://www.travelsomerset.co.uk/>

Junction 25 Somerset CC Webpage <https://www.travelsomerset.co.uk/j25/>